

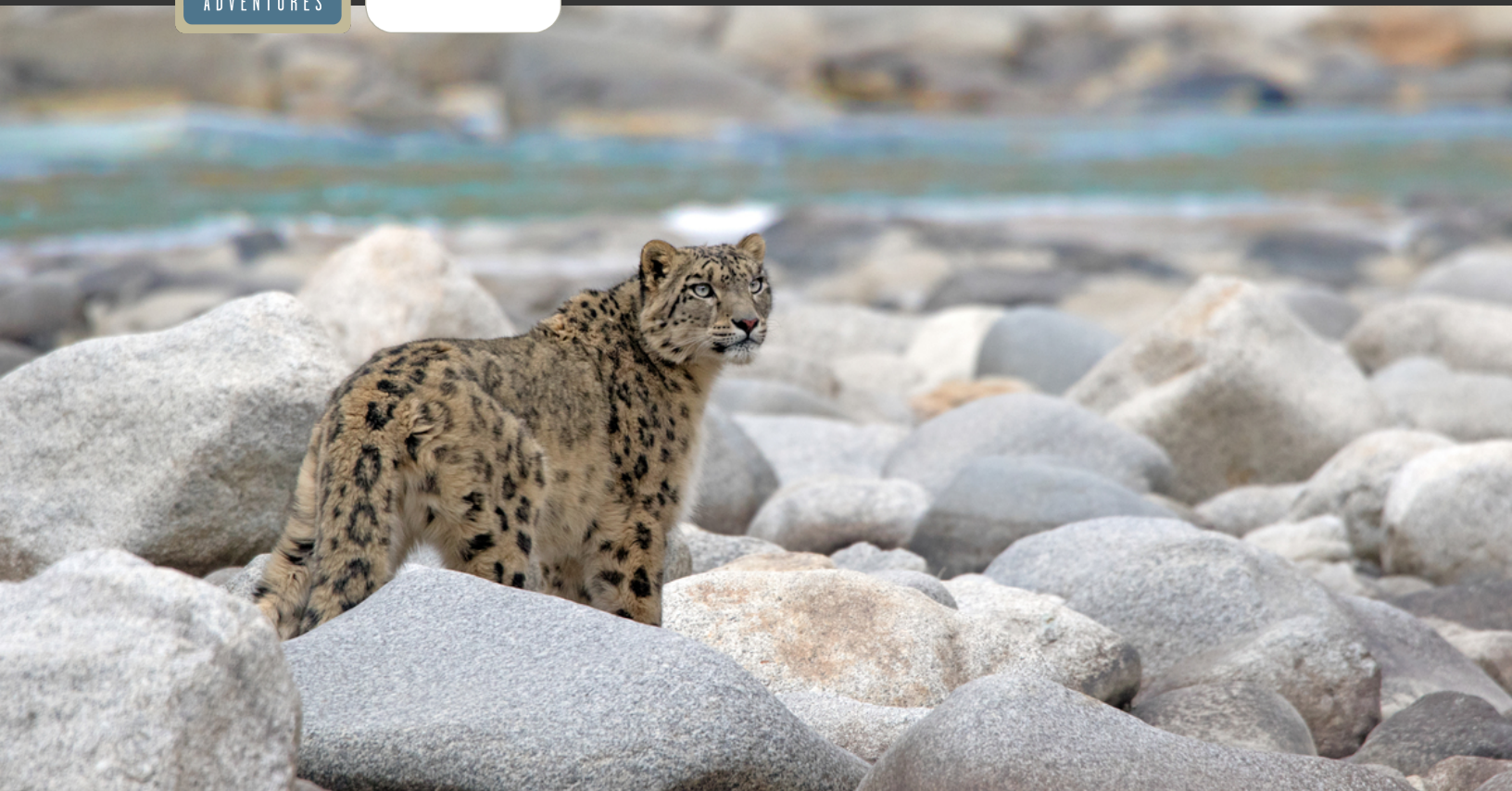

Discovering Our Planet Together



# Snow Leopard Quest Photo Expedition

*A Himalayan Adventure in Pursuit of One of Earth's Rarest and Most Beautiful Cats*



## Table of Contents:

---

|  |       |           |
|--|-------|-----------|
| <b>Trip Overview</b>                   | ..... | <b>3</b>  |
| <b>Trip Itinerary</b>                  | ..... | <b>4</b>  |
| <b>Trip Accommodations</b>             | ..... | <b>8</b>  |
| <b>What Makes Nat Hab Different?</b>   | ..... | <b>10</b> |
| <b>Make It Private</b>                 | ..... | <b>13</b> |
| <b>Dates &amp; Pricing Information</b> | ..... | <b>14</b> |
| <b>Trip Extensions</b>                 | ..... | <b>20</b> |



Discovering Our Planet Together

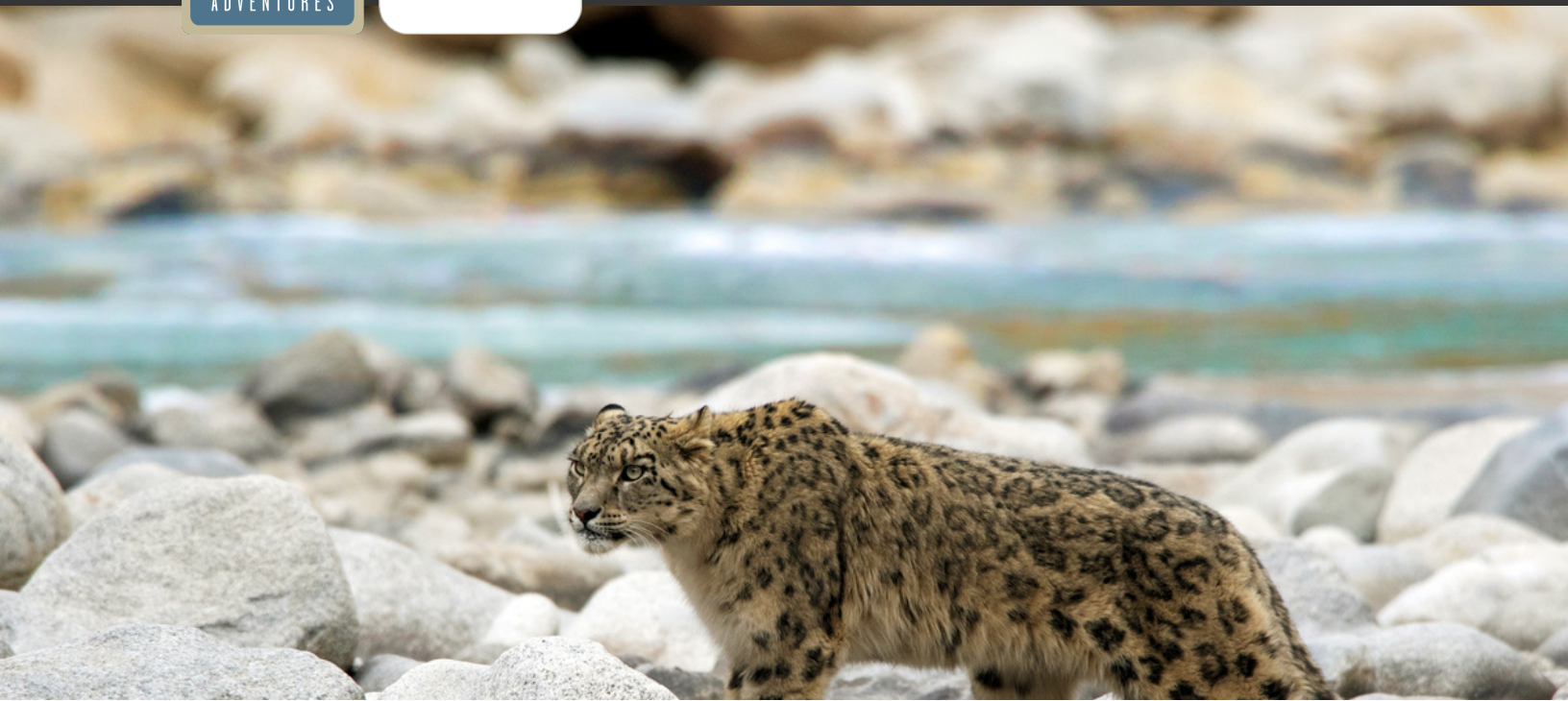

### Trip Details:

**Days:**  
11 Days / Mar & Apr

**Price:**  
From \$11995 (+ Air)

**Physical Requirements:**  
Difficult

## Snow Leopard Quest Photo Expedition

### A Himalayan Adventure in Pursuit of One of Earth's Rarest and Most Beautiful Cats

The snow leopard is a creature of legend in the alpine heights of the Indian Himalaya. Known locally as the "gray ghost," they are rarely seen, since they are masters of camouflage and live on steep, rocky slopes. For wildlife photographers, this gorgeous cat is a coveted prize—and we travel with some of the best snow leopard trackers in the world in pursuit of images that few will ever have a chance to attain. Based out of a deluxe, family-owned ecolodge with thick walls, insulated windows, radiant floor heating and abundant hot running water in a remote valley in Ladakh, we spend a full week in the snow leopard's terrain, heading out each day in search of them. Other wildlife thrives in this austere landscape, too: keep your camera poised for shots of bharal, urial, argali and ibex—the wild mountain sheep and antelope that are the snow leopard's prey—as well as Himalayan wolf, fox, and raptors soaring overhead, including the Himalayan golden eagle and lammergeyer, with its 10-foot wingspan.

### Trip Highlights

With top trackers and guides, pursue photos of snow leopards and other Himalayan wildlife such as bharal, urial, ibex and Himalayan wolves

On this in-depth photography immersion, spend seven nights at a private mountain lodge in snow leopard territory adjacent to Hemis National Park, with the region's most experienced naturalist guides

Our deluxe, newly built mountain lodge features en suite heated showers, radiant floor heating and floor-to-ceiling windows throughout—and it's for our exclusive use





Discovering Our Planet Together



## Itinerary At A Glance

- Day 1**  
Delhi, India / Gurgaon
- Day 2**  
Delhi / Leh, Ladakh
- Day 3**  
Leh—Indian Himalaya  
Photography
- Days 4–9**  
Snow Leopard Photography  
from Rumbak—Private  
Expedition Lodge
- Day 10**  
Rumbak / Leh
- Day 11**  
Leh / Delhi / Depart

## Snow Leopard Quest Photo Expedition Itinerary

A Himalayan Adventure in Pursuit of One of Earth’s Rarest and Most Beautiful Cats

### Day 1: Delhi, India / Gurgaon

Arrive at the international airport in India’s capital, steeped in centuries of layered history, and transfer to our luxury hotel in the high-tech suburb of Gurgaon outside the city center. This elegant contemporary low-rise hotel is surrounded by seven acres of gardens, courtyards and reflecting pools, lending a resort-like ambience. This evening, join our Expedition Leader for a welcome dinner and preview of our journey into the Indian Himalaya and the realm of *Panthera uncia*, the snow leopard.







### **Day 2: Delhi / Leh, Ladakh**

Early this morning, we fly north to the former Himalayan kingdom of Ladakh. This is one of India's least-populated regions, known for dramatic peaks, monasteries filled with golden Buddhas, and the elusive snow leopards that prowl the snowfields that blanket these dry, rocky mountainsides. Once we touch down at 11,500 feet in the capital city of Leh, our high-altitude acclimatization begins. For centuries, Leh was a crossroads for Indus Valley trade between Tibet, Kashmir, India and China—routes that carried salt, cashmere wool, indigo and silk. The local people are ethnic Tibetans who speak Ladakhi, and Buddhism and Islam have co-existed peacefully here since the 8th century. Our lodging in the heart of this ancient city sits in the shadow of an unoccupied 17th-century palace designed to evoke the Dalai Lama's former residence in Lhasa—the famous Potala Palace. The rest of the day is at leisure as we settle in and adjust to the high elevation.

### **Day 3: Leh—Indian Himalaya Photography**

Today we travel into Leh's rural surroundings, exploring the rugged Indus River Valley. It's easy to see why this enclave at the northern tip of India is often called "Little Tibet," as we cross passes marked with colorful prayer flags beneath soaring Himalayan peaks. As we climb up this crenelated region where the Indian and Asian continents collided, be on the lookout for blue sheep, golden eagles and bearded vultures.

We stop in Gya, one of the oldest villages in Ladakh that is perched on a gorge overlooking the river. A contingent of villagers greets us with a traditional welcome before leading us on a guided tour of their colorful town. We learn about animal husbandry, handicrafts and textiles, along with traditional barley roasting and cooking. Archery is an important element of traditional Ladakh life, and we stop at a range where we have the opportunity to witness archers in their element—and to participate! After a traditional lunch in a local home, we set out on foot with our guide to explore the picturesque landscape. Here we have a high likelihood of seeing more birdlife and blue sheep. We return to Leh by late afternoon.



#### **Days 4–9: Snow Leopard Photography from Rumbak—Private Expedition Lodge**

The heart of our adventure begins in the village of Rumbak, where our private expedition lodge is located. From this base, we'll spend six nights tracking and photographing snow leopards. To reach the lodge, we follow the Indus River, stopping to visit the Stakna Buddhist Monastery, built in the 16th century and whose name means "tiger's nose," a reference to the shape of the hill on which it was built. We breakfast with the monks before continuing up the Indus River Valley toward Rumbak and our expedition base. This region is the gateway to a high-altitude realm ruled by the "ghost of the mountains"—a name bequeathed upon the snow leopard for its solitary and elusive nature. As we drive, be on the lookout for ibex, noted for their magnificent horns, standing vigil over rocky outcrops and couloirs.

Recently constructed using traditional Ladakhi techniques and materials, including stone, mud and timber, all chosen for their natural insulating properties, ours is the most luxurious lodge in the region. Blending seamlessly into its surroundings, it features radiant floor heating, abundant running hot water and double-glazed windows for an intimate and warm experience.

Over the next six days, we search the alpine heights for snow leopards in and around Hemis National Park, which holds the highest density of snow leopards in any protected area in the world—about 200. These trans-Himalayan cats have evolved to thrive in some of Earth's harshest alpine terrain, mostly above tree line and up to 18,000 feet in elevation. Our base for exploration is a private ecolodge set on a plateau with unimpeded views of the snowcapped mountains and Rumbak River below. The nearby village of Rumbak, population 250, is a short walk away. The surrounding landscape provides habitat for three large ungulates—ibex, bharal (blue sheep) and urial (mountain sheep)—along with fox, hare, pika and packs of Tibetan wolves.

For our best chance to see snow leopards, we rely on the expertise and keen eyes of a team of local spotters, plus our naturalist Expedition Leader. These seasoned trackers scour the landscape early each morning to help us plan our route for the day and increase our luck of seeing these cats whose camouflage enables them to blend in seamlessly with their habitat. We also retain radio contact with trackers throughout the day, so we know when snow leopards wander into our area. Private vehicles maximize our flexibility to move to where the snow leopards are. Typically, we spot them on high ridges around our lodge or within a short walk from the vehicles, but longer hikes are available for those who desire.

Snow leopards have evolved to thrive in some of Earth's harshest alpine terrain, mostly above tree line and up to 18,000 feet in elevation, across the Himalayas. Typically, we spot them atop a high ridgeline, when a long lens is a necessity. On other occasions, we are graced with closer sightings, sometimes even around the lodge, which offers a cozy respite for warming up with hot chai between photography outings. The surrounding sheer cliffs and broad meadows provide habitat for three large ungulates—bharal, ibex and urial—along with fox, hare, pika and packs of Himalayan wolves. In the valley's narrowest reaches, steep walls and side streams sustain a healthy population of ibex that lures snow leopards, which are capable of killing prey up to three times their own weight.





Our nearest neighbors in Rumbak are warm and welcoming. Nearby are intriguing Ladakhi cultural sites like Buddhist temples and monasteries that we visit if time allows.

At every turn, photo opportunities abound, whether wildlife, landscapes or cultural settings. In the evenings, our Expedition Leader hosts workshops and editing sessions to help you take your photography to the next level.

### **Day 10: Rumbak / Leh**

After breakfast, enjoy a final morning in scenic Rumbak, relishing our last chance to photograph this alpine domain. Later, say farewell to our gracious Ladakhi hosts whose lodge enterprise is enhancing protection for snow leopards through ecotourism. The cats face threats from habitat loss due to climate change, reduced prey, poaching and human conflict, and we leave knowing we have made a difference for their future with our economic contribution and our advocacy. In Leh we attend a private culinary immersion at a local Ladakhi kitchen. Later this evening, we share our reflections over a farewell dinner.

### **Day 11: Leh / Delhi / Depart**

Fly from Leh to Delhi this morning and continue to our hotel where an overnight room is reserved. A lavish lunch awaits at the hotel, followed by time to relax among landscaped gardens and pools. A transfer to the international airport is included to meet departing flights this evening.



Discovering Our Planet Together



### Accommodation Details:

Trident Gurgaon

The Grand Dragon Ladakh

House of Rumbak Wildlife Lodge

JW Marriott Hotel New Delhi Aerocity

For detailed descriptions, visit [nathab.com/asia-adventure-travel/himalayan-snow-leopard-photo-tour/accommodations/](http://nathab.com/asia-adventure-travel/himalayan-snow-leopard-photo-tour/accommodations/)

## Snow Leopard Quest Photo Expedition Accommodations

A Himalayan Adventure in Pursuit of One of Earth's Rarest and Most Beautiful Cats



### Trident Gurgaon

Set among landscaped gardens, courtyards, reflection pools and fountains, this contemporary oasis offers resort-style ambience in a serene setting away from the bustle of Delhi, just 30 minutes from the airport.

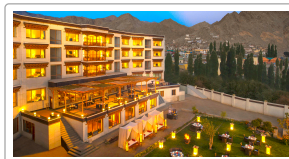

### The Grand Dragon Ladakh

In the heart of ancient Leh, enjoy the luxuries of Ladakh's premier 5-star hotel, combining elements of traditional Ladakhi art and culture with state-of-the-art amenities and expansive views of snowcapped peaks.



### House of Rumbak Wildlife Lodge

Located at 12,800 feet above sea level and offering excellent proximity for snow leopard tracking, this new ecolodge provides a warm and cozy base exclusively for Nat Hab guests.





Discovering Our Planet Together

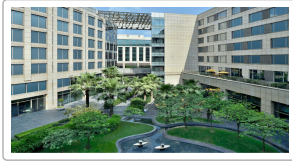

**JW Marriott Hotel New Delhi Aerocity**

Conveniently located near New Delhi's international and domestic airports, this stylish, contemporary hotel offers a blend of luxury and convenience, with high-end amenities.



## The World's Best Opportunity for Snow Leopard Photography

Photographing snow leopards in the wild is one of the most exclusive travel quests on the planet—and no one can help you attain that goal like we can! Visiting high-altitude Ladakh in winter or spring is a daunting prospect on your own—so let us handle all the details. This is the photo expedition of a lifetime you need our expertise for!

### 1 No Better Place to Seek Snow Leopard Photos

Called the "gray ghost" by locals, a moniker that attests to its elusiveness, the snow leopard is a rare creature that has been virtually "unseeable" to many who go in search of it. But that is changing, as conservation becomes a priority in northern India. As the Snow Leopard Conservancy-India Trust continues to work with local villagers to protect these cats, sightings—and photo opportunities—are up.

### 2 Top Spotters, Trackers and Guides Enhance Your Odds

If you want the best chances to photograph elusive snow leopards and other Himalayan wildlife, you must have access to a superlative local team. Based at our private lodge in snow leopard territory, we spend seven days with the finest trackers and naturalists, including our professional photographer Expedition Leader who coordinates the entire effort. Adept spotters, who are the region's top local trackers, attempt to locate the cats each morning and stay in constant radio contact regarding their movement. We plan our days with utmost flexibility so we can follow the snow leopards' paths accordingly.

### 3 Our Private Expedition Lodge is an Optimal Base

Our stunning and environmentally conscious ecolodge—for our exclusive use—provides unparalleled comfort with en suite bathrooms, running hot water, radiant floor heating and gourmet meals. Built in the region's traditional architectural style, the lodge's fine details plus proximity to snow leopards and other Himalayan wildlife are the ultimate in luxury.

### 4 A Small Group is Essential to Maximize Photography Opportunities

With just eight photographers, our small group has a quiet, non-obtrusive presence, upping our chances of encountering snow leopards and other wildlife.

### 5 Private Vehicles Ensure Maximum Flexibility

We use private vehicles for maximum flexibility, allowing us to seek out snow leopards and other wildlife such as Tibetan wolves, urial, blue sheep, ibex and lammergeyers, wherever they are found.





### **6** Local Porters Help Carry Your Gear

We'll be covering some challenging mountain terrain as we hike in search of snow leopards, and it's easier to walk without being encumbered by heavy, bulky photography equipment. We've hired porters from the community to take the load off, hauling whatever you need them to carry until we are in range for photography.

### **7** Our Presence Directly Helps to Protect Snow Leopards

Snow leopards are a vulnerable species under threat from habitat loss, climate, retaliatory killings, and poaching. Their range continues to decline from human settlement, while a warming climate could diminish up to 30% of their terrain in the Himalayas. Responsible tourism is part of the solution. As conservation travelers, the investment we make to photograph Ladakh's snow leopards benefits local communities. Our being there creates an incentive to protect wild creatures they share the land with. In addition, we will make a donation to the Snow Leopard Conservancy-India Trust for each photographer on this expedition.

### **8** Travel with India's Finest Wildlife Photography Guides

Our India naturalist Expedition Leaders average more than 15 years' experience—with top-level training including resources from WWF scientists. And of course, your guide is also an accomplished professional photographer adept in capturing coveted images of snow leopards and other Himalayan wildlife—and by your side to share tips. You won't find more knowledgeable, personable or enthusiastic guides than those who are proud to work for us. Our philosophy is simple: a nature adventure is only as good as the guide who leads it, so we provide the very best!

### **9** An Immersion in Ladakh's Rich Tibetan Buddhist Culture

While Ladakh is part of India, it stands apart. Ladakh gained status as a separate union territory in 2019, and this Himalayan state is often referred to as "Little Tibet." As ethnic Tibetans whose cultural and spiritual traditions have been left alone to thrive in a remote mountain environment, their long and vibrant Buddhist history continues to influence everything from roadside prayer flag installations to well-maintained ancient monasteries where monks reside and practice. Absorb Ladakh's cultural sites in a quiet, non-touristy way, including our stay among yak-herding locals in the small Himalayan village of Mangyu.

### **10** Our Quality-Value Guarantee Ensures Your Snow Leopard Photo Expedition

With Natural Habitat Adventures, you receive our exclusive quality value guarantee that promises we will meet the high expectations we set forth in our promotional materials. To our knowledge, this is the most ambitious guarantee made by any adventure travel company.



**11** **Feel Good About Your Carbon-Neutral Journey**

We care deeply about our planet, as we know you do. When you travel with us, the carbon emissions from your trip are 100% offset—including your round-trip flights from home. Natural Habitat Adventures has been the world's first carbon-neutral travel company since 2007.





Discovering Our Planet Together

## Make It Private with Your Family or Friends

Travel privately, exclusively with your immediate family, multi-generational family or group of friends. And when you choose a private departure, you're assured the most exclusive and authentic Snow Leopard Quest Photo Pro Expedition on offer. Request your private departure by completing the form below.

Please note that on Snow Leopard Photo Expedition Make It Private departures we require a minimum group size of 5 travelers.

Also, please be aware that your per-person cost on a Make It Private trip will vary depending on the number of travelers in your group and may be as much as 10%-30% higher (ship-based trips may be even higher) than our normal trip cost unless you fill the trip.

---

This **Make It Private** option is available on nearly every Nat Hab trip for family and friend groups. Call an Adventure Specialist at 800-543-8917 or look for the "Make It Private" icon in the **pricing section** of a trip online at [nathab.com](http://nathab.com) to see prices based on your specific group size.



Discovering Our Planet Together



## Dates & Pricing Summary:

**Prices:**  
From \$11995  
(+ Air)

**Group Size:**  
Please note that on Make It Private departures we have a minimum group size of half the maximum size of our regularly scheduled departures.

**Physical Requirements:**  
Difficult

## Snow Leopard Quest Photo Expedition Dates, Pricing & Info

A Himalayan Adventure in Pursuit of One of Earth's Rarest and Most Beautiful Cats

### 2025 Departures

| Departure    | Return       | Notes  |
|--------------|--------------|--|
| Mar 19, 2025 | Mar 29, 2025 | Pair with our India Tiger Photo Expedition or Nepal & Bhutan trip* |

### 2026 Departures

| Departure    | Return       | Notes   |
|--------------|--------------|---|
| Mar 15, 2026 | Mar 25, 2026 | Pair with our India Tiger Photo Expedition, Grand India or Nepal & Bhutan trip*               |
| Mar 22, 2026 | Apr 1, 2026  | Pair with our India Tiger Photo Expedition, Grand India, Tiger Quest, or Nepal & Bhutan trip* |
| Mar 29, 2026 | Apr 8, 2026  | Pair with our India Tiger Photo Expedition, Grand India, Tiger Quest, or Nepal & Bhutan trip* |
| Apr 4, 2026  | Apr 14, 2026 | Pair with our India Tiger Photo Expedition, Grand India, Tiger Quest, or Nepal & Bhutan trip* |



### Dates & Pricing Summary:

**Prices:**

From \$11995  
(+ Air)

**Group Size:**

Please note that on Make It Private departures we have a minimum group size of half the maximum size of our regularly scheduled departures.

**Physical**

**Requirements:**

Difficult

Departure      Return      Notes

**2027 Departures**

Departure      Return      Notes

|              |              |  |
|--------------|--------------|--|
| Mar 16, 2027 | Mar 26, 2027 |  |
| Mar 23, 2027 | Apr 2, 2027  |  |
| Mar 30, 2027 | Apr 9, 2027  |  |
| Apr 5, 2027  | Apr 15, 2027 |  |





## Pricing

### 2024 Prices

➤ **Trip Price**

\$12795 (+internal air)

**Internal Air Cost:** \$587 per person (this will be listed separately on our invoicing)

**Single Occupancy:** For a single room add \$3495.

**Deposit:** \$500 per person (nonrefundable)

Trip prices are per person based on double occupancy and are given in U.S. dollars.

### 2025 Prices

➤ **Trip Price**

\$11995 (+internal air)

**Internal Air Cost:** \$634 per person (this will be listed separately on our invoicing)

**Single Occupancy:** For a single room add \$3695.

**Deposit:** \$500 per person (nonrefundable)

Trip prices are per person based on double occupancy and are given in U.S. dollars.

### 2026 Prices

➤ **Trip Price**

\$12895 to \$13195 (+internal air)

**Internal Air Cost:** \$672 per person (this will be listed separately on our invoicing)

**Single Occupancy:** For a single room add \$2995.

**Deposit:** \$500 per person (nonrefundable)

Trip prices are per person based on double occupancy and are given in U.S. dollars.

Trip prices are per person based on double occupancy and are given in U.S. dollars.

### 2027 Prices

We're still in the process of confirming 2027 pricing. Please contact an Adventure Specialist for more details: 800-543-8917.

Trip prices are per person based on double occupancy and are given in U.S. dollars.

## Included

- **Trip price includes:** Accommodations, services of Nat Hab's professional photo Expedition Leader(s), local guides, spotters and lodge staff, local porter to assist with carrying gear, all meals from dinner on Day 1 through lunch on final day, local wine and beer at dinner while at the Snow Leopard Lodge, some gratuities, airport transfers on Day 1 and final day, donation fees to the Snow Leopard Conservancy, all activities and entrance fees, all taxes, permits and service fees.
- **Internal air cost includes:** All flights within the itinerary, additional luggage allowance (this will be listed separately on our invoicing).





## Not Included

Travel to and from the start and end point of your trip, alcoholic beverages (other than those listed above), some gratuities, passport and visa fees, optional activities, items of a personal nature (phone calls, laundry and internet, etc.), airline excess baggage fees, required medical evacuation insurance, optional travel protection insurance.

## Physical Requirements

### *Difficult*

This is a remote and rugged nature expedition with snow leopard photography the primary objective. Good health and general physical fitness and mobility are essential to participate in this trip. Our schedule is flexible to accommodate the movement of snow leopards and other wildlife. Sometimes we may spot wildlife directly on the mountain ridges surrounding our lodge, while other times we may need to drive 30 minutes or more to nearby valleys.

When our trackers spot wildlife, we often need to walk short distances from our lodge or vehicles to get the best views. In cold temperatures and at altitudes of 12,000 to 14,000 feet, hiking can feel strenuous, even though it will not be overly taxing in terms of distance and elevation gain. Although our walks are generally shorter in nature, as a guideline, travelers must be capable of hiking a minimum of 2 miles daily (in total, with stops) at a relaxed pace on narrow, rocky trails that may be covered with snow and ice. We may also walk off-trail at times, which requires extra agility and stability. Our staff is available to assist for safety purposes, but travelers must be able to comfortably negotiate uneven and unstable conditions, at extremely high altitudes, on their own. Longer or more strenuous optional hikes may be offered, too, to access additional areas of exceptional scenic beauty and photography opportunities.

Our days start early. On the days dedicated to tracking and photographing snow leopards, expect to be outdoors for two or more hours at a time in cold weather, though wearing proper boots and clothing will ensure your comfort. Weather can be variable, and travelers should be prepared for the possibility of high winds, intense sun and very cold temperatures. Heavy snowfall is not uncommon. Average daytime temperatures in this part of the Himalaya can range from the low teens to 30 F. Evenings and early mornings can be extremely cold, with temperatures dropping below zero and wind chill that may make it feel even colder.

Ladakh is a high-altitude desert. The capital, Leh, lies above 11,000 feet. Our lodge in the Rumbak Valley sits at 12,800 feet and activities take place between 12,000 and 14,000 feet. At these elevations, it is possible that some individuals may experience altitude sickness. We recommend consulting your doctor about bringing altitude-sickness medication with you, since it is impossible to predict who may be affected. Travelers with a history of medical problems—particularly cardiac or respiratory ailments—should consult a doctor before deciding to participate in this expedition.

The drive to our expedition-style lodge takes approximately 1 hour from Leh, depending upon local conditions, and involves travel on very narrow, winding mountain roads with steep drop-offs. Although oxygen is provided at the lodge if required, Leh offers the closest comprehensive medical care. Flight transfers require walking with luggage through airports and climbing stairs to board and disembark planes.



## Important Information About This Trip

Our snow leopard photo expedition is a conservation-focused adventure designed to provide accomplished photographers with the best chances to go home with coveted wildlife images. It's meant for intrepid travelers with a desire for deeper discovery, and an awareness that staying in the very heart of wild snow leopard habitat is the ultimate luxury. We spend seven nights in the best area for potential sightings, but there are no guarantees we will see this elusive animal. Many sightings occur in the distance, on mountain ridges and through scopes—but they are thrilling nonetheless! We visit during the Himalayan winter and early spring, and weather and high-altitude conditions are sometime hostile. Essential requirements for travel in Ladakh include flexibility, a sense of humor, a true spirit of adventure, and an openness to the unexpected.

### **Accommodations**

Because of its location and the staff's commitment to our guests, our Private Snow Leopard Lodge offers the most comfortable and authentic way to view snow leopards in the wild. Accommodations there are simple and comfortable, with twin or queen-sized beds and warm bedding, 24-hour electricity, electric and wood-burning stove heat and private en suite Western toilets and sink basins. While there is no running water, hot water is supplied on demand for washing, including bucket-style showers. Because it is a small, Ladakhi-style lodge, you will reside in relatively close quarters with fellow travelers. Thus, a flexible and tolerant attitude toward other participants is paramount for the enjoyment of all. While considered rustic by our usual standards, all in all a stay at the Snow Leopard Lodge is one of the most inspiring and memorable hotel experiences in the world of adventure travel!

### **Wildlife Viewing in Ladakh**

When viewing wildlife in Ladakh, guests will be stationary for long periods of time. After reaching the point of a snow leopard sighting and setting up, we may be seated and simply waiting for any wildlife movement for the majority of the morning or afternoon. Hot refreshments and seating will be provided by our lodge for all outings.

Additionally, the distance from which we typically view wildlife on this trip is extremely far—often miles across a valley on the opposite mountainside or on the top of a mountain ridge line. While it's possible sightings can be closer – and unforgettable when they are – typically, we will be viewing wildlife from far away. This is when proper camera equipment and spotter's scopes will help to bring that wildlife into focus, and we will make use of this equipment for all sightings.

Landscape serving as the backdrop can also present challenges when viewing wildlife in Ladakh. These animals are adapted to this mountainous environment and remarkably can blend into the intricate jagged rocks of a mountainside. While the expert eyes of our spotters are well accustomed to spotting wildlife in this setting, it can take patience to spot creatures against the mountains for most visitors.

### **Safety & Health**

Your safety is of paramount importance to us. Toward that end, we provide highly competent guides and local staff with extensive experience in high-altitude terrain. Our Expedition Leaders are thoroughly trained in emergency wilderness first-aid techniques. Ultimately, our guides and local staff make decisions with everyone's comfort and safety in mind, while trying to maximize the adventure experience for each individual. Listening carefully to your Expedition Leader's instructions and



directions is ultimately your responsibility, and your astute attention is always in your best interest and that of the group.

Oxygen is available at all times at our expedition lodge. A military hospital is 1 hour away in Leh. Anyone who experiences acute mountain sickness will immediately be taken down to a lower altitude for treatment at the hospital in Leh.

#### ***Meals***

Meals are hearty and delicious, are they are specially planned and prepared for well in advance. Dietary requirements due to serious medical conditions or strict personal restrictions can be met with ample notice, but must be adhered to while on the adventure.

#### ***Communication***

There is no Wi-Fi or cell reception at our expedition lodge. There are nearby areas where our guides can drive for cell service.

### **Mandatory Insurance**

Since the areas we travel to are remote and wild (that's why we go there!), we require that all guests have, at minimum, medical evacuation insurance for this program. This is for the safety of all guests. We require that your chosen independent insurance plan includes at least \$250,000 in medical evacuation coverage.

To protect your investment and to provide peace of mind while you travel, we also strongly recommend purchasing comprehensive travel insurance. Plans may cover everything from medical treatment to trip cancellations and delays and lost luggage. Please contact our office if you would like more information about the medical evacuation and comprehensive travel insurance policies we offer by calling 800-543-8917.

### **Getting There & Getting Home**

You should plan to arrive in Delhi by 2 pm on Day 1 in order to participate in an orientation and group welcome dinner beginning at approximately 5:30 pm. You are free to depart Delhi any time after 8 pm on the final day.

We can best serve you if our Natural Habitat Adventures Travel Desk makes your reservations, as we are intimately familiar with the special requirements of this program and can arrange the most efficient travel. Please call us at 800-543-8917. Note that while we offer you the best possible rates available to us on airfare and additional nights' accommodations, you may find special web rates or better fares online.





Discovering Our Planet Together



### Extension Details:

**The Grand India Wildlife Adventure**  
\$12395

**India Tiger Quest — Ranthambore 2025**  
\$9495

**Wild & Ancient Himalaya: Nepal & Bhutan**  
\$13295

**India Tiger Photo Expedition — Ranthambore 2025**  
\$17995

**Sri Lanka Wildlife & Cultural Treasures**  
\$11595

## Snow Leopard Quest Photo Expedition Extensions

A Himalayan Adventure in Pursuit of One of Earth's Rarest and Most Beautiful Cats



### The Grand India Wildlife Adventure

Look for rare Bengal tigers, one-horned rhinos and other endangered animals as we discover India's wild side on an exploration of three premier national parks. You won't find a richer Indian nature safari!

**\$12395 (+air)**



### India Tiger Quest — Ranthambore 2025

Deep within the jungles of Rajasthan, Ranthambore National Park offers some of India's most famous tiger viewing—and we take you there at the very best time of year to find them.

**\$9495**



### Wild & Ancient Himalaya: Nepal & Bhutan

Explore mountain heights and jungle lowlands on this soulful journey through the cultural and wildlife treasures of two neighboring Himalayan nations—including rhino tracking in Chitwan National Park.

**\$13295 (+air)**



Discovering Our Planet Together



### **India Tiger Photo Expedition — Ranthambore 2025**

11 days, including multiple tiger safaris in Ranthambore National Park, plus the Pink City of Jaipur, Jhalana Leopard Reserve, and Agra, to photograph the Taj Mahal and Red Fort.

**\$17995**



### **Sri Lanka Wildlife & Cultural Treasures**

In this biodiversity hotspot, virgin rain forests shelter monkeys, tropical birds and leopards while gigantic blue whales cruise offshore. Discover World Heritage wonders in a beguiling melange of nature and culture.

**\$11595**



**Natural Habitat & WWF: Discovering Our Planet Together**

Natural Habitat Adventures • PO Box 3065 • Boulder, CO 80307

USA & Canada: 800-543-8917 • International: +1-303-449-3711

© 2025 Natural Habitat Adventures

WWF's membership travel program is operated by Natural Habitat Adventures (Nat Hab). To date, Nat Hab has provided more than \$6 million in support of WWF's mission and will continue to give 1% of gross sales plus \$175,000 annually through 2028. WWF® and ©1986 Panda Symbol are owned by WWF. All rights reserved.